

METAL SAFETY QUICK COUPLINGS - CSM 11

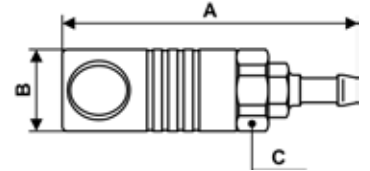

Hose tail coupler

Profile : ISO 6150C



Min / Max operating pressure	Flow rate at 6 bar	ID passage	Min. / Max temperature
2 / 16 bar	4120 l/min	11 mm	-15 / 70 °C

Part number	For hose ID	Dim. A (mm)	Dim. B (mm)	Dim. C (mm)
CSM 111810	10 mm	119	33	30
CSM 111813	13 mm	112	33	30
CSM 111816	16 mm	111	33	30
CSM 111819	19 mm	147	33	30